

# Vexor Custom Woodworking Tools Multiple Profile System Assembly Sheet

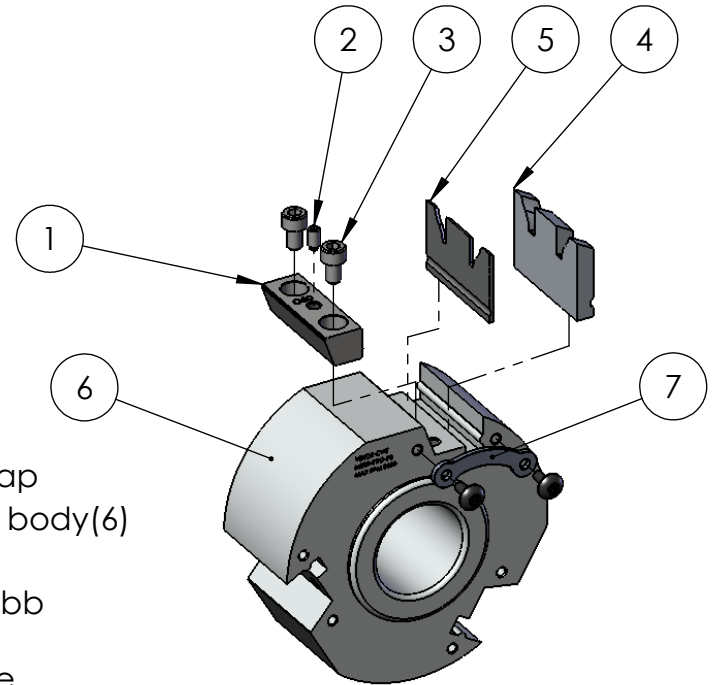

## Removal

1. Using a 5mm allen wrench loosen the two cap screws(3)fastening the gibb(1) to the cutter body(6)
2. To unwedge gibb use a 3mm allen wrench to turn the set screw(2) clockwise until the gibb breaks free.
3. Now it is possible to slide the insert(5) and the backer(4) from the cutter head(6).  
{It is not necessary to remove gibb(1)}
4. Clean the area where the insert(5) and backer(4) reside. This allows for the most precise locating for insert(5).

## Replacement

5. Slide backer(4) into the cutter body(6) until it meets the CJ Bridge Assembly(7).
6. While lifting the gibb(1) slightly off of the cutter body(6) slide the insert(5) into place keeping the slot aligned with the gibb's(1).
7. Before locating the insert(5) and tightening the cap screws(3) the set screw(2) must be loosened until it becomes flush with the surface of the gibb(1)
8. Once the set screw(2) is in place apply pressure downward and towards the CJ Bridge Assembly(7) with the insert(5) and backer(4).
9. After the insert(5) is bottomed out in the seat and flush against the CJ Bridge Assembly(7) snug up both cap screws(3)
10. Once snug, fully tighten the cap screws(3)
11. For accuracy a dial indicator can be used to check for run-out from wing to wing.

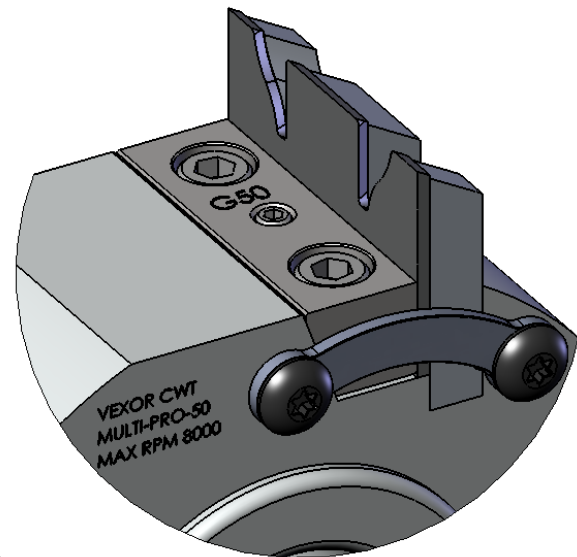

## Warning

-Do Not Loosen Or Remove CJ Bridge Assembly(7)

-It is not recommended to remove gibbs(1) unless damaged or for cleaning purposes